

MODEL 'M' or 'S' STYLE VENT FOR CLAY TILE ROOFS  
(www.chingvent.com)

NET FREE VENT AREA = 86.25 SQ. IN.

**ATTIC VENT CALCULATION @ (E) HOUSE (N) ROOF:**  
 $1,934 \text{ SQ. FT.} / 150 = 12.89 \text{ SQ. FT. OF VENT REQUIRED}$   
 USING 3-12X18 VENTS = 4.5 SQ. FT.  
 PLUS 14-MODEL 'M' or 'S' STYLE VENTS FOR CLAY TILE ROOFS  
 $14 \times 86.25 \text{ SQ. IN.} = 1207.5 \text{ SQ. IN. or } 8.39 \text{ SQ. FT.}$   
**TOTAL VENT PROVIDED = 12.89 SQ. FT.**

**1st. FLOOR ROOF PLAN**  
SCALE: 1/4" = 1'

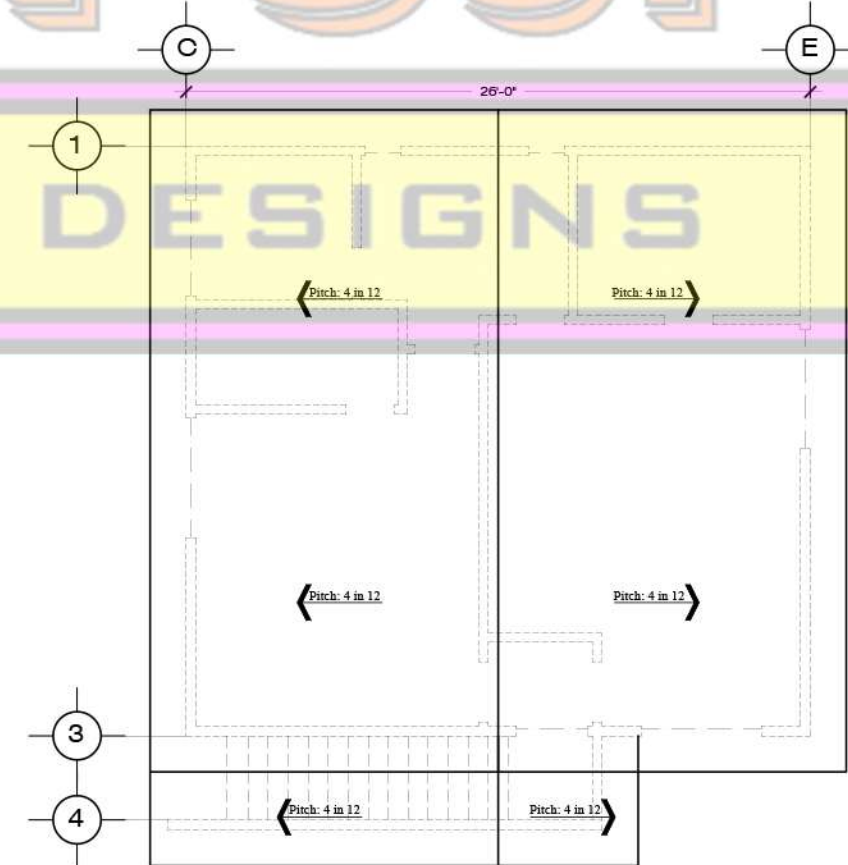

**2nd. FLOOR ROOF PLAN**  
SCALE: 1/4" = 1'

**IGNITION-RESISTANT CONSTRUCTION NOTES:**

- 1) **WALLS:** EXTERIOR WALL SURFACES SHALL BE NON-COMBUSTIBLE (STUCCO, MASONRY, CEMENT FIBER BOARD, ETC.), IGNITION-RESISTANT, HEAVY TIMBER OR LOG WALL CONSTRUCTION. (COUNTY BUILDING CODE 704A.3.1)
- 2) **EAVES:** EAVES, SOFFITS AND FASCIAS SHALL BE CONSTRUCTED IN CONFORMANCE WITH GUIDANCE DOCUMENT DPLU #198. (COUNTY BUILDING CODE 704A.2.3)
- 3) **UNENCLOSED UNDERFLOOR:** UNDERFLOOR AREAS SHALL BE ENCLOSED TO THE GROUND WITH NON-COMBUSTIBLE OR IGNITION-RESISTANT WALLS. (COUNTY BUILDING CODE 704A.4.2.2)
- 4) **VENTS:** VENTS ARE NOT PERMITTED IN OVERHANG AREAS. VENTS SHALL RESIST THE INTRUSION OF FLAMES AND EMBERS OR SHALL BE PROTECTED BY LOUVERS AND 3-INCH NON-COMBUSTIBLE, CORROSION-RESISTANT METAL MESH. (COUNTY BUILDING CODE 704A.2.1 & 704A.3.2.1)
- 5) **GLAZING:** EXTERIOR WINDOWS, WINDOW WALLS, GLAZED DOORS, AND GLAZED OPENINGS WITHIN DOORS SHALL BE DUAL-GLAZED UNITS WITH A MINIMUM OF ONE TEMPERED PANE OR SHALL BE GLASS BLOCK UNITS OR SHALL HAVE A FIRE-RESISTANCE RATING OF NOT LESS THAN 20 MINUTES. GLAZING FRAMES MADE OF VINYL SHALL HAVE WELDED CORNERS AND METAL REINFORCEMENT IN THE INTERLOCK AREA. (COUNTY BUILDING CODE 704A.3.2.2)
- 6) **SKYLIGHTS:** SKYLIGHTS SHALL BE TEMPERED GLASS. (COUNTY BUILDING CODE 704A.1.6)
- 7) **ROOF GUTTERS:** ROOF GUTTERS SHALL BE PROVIDED WITH THE MEANS TO PREVENT THE ACCUMULATION OF LEAVES AND DEBRIS IN THE GUTTER. (COUNTY BUILDING CODE 704A.1.5)
- 8) **EXTERIOR DOORS:** EXTERIOR DOORS SHALL BE APPROVED IGNITION-RESISTANT CONSTRUCTION, SOLID-CORE WOOD NOT LESS THAN 1" THICK, OR HAVE FIRE PROTECTION RATING OF NOT LESS THAN 20 MINUTES. (COUNTY BUILDING CODE 704A.3.2.3)
- 9) **DECKING AND OTHER BUILDING APPENDAGES:** EXTERIOR BALCONIES, CARPORTS, DECKS PATIO COVERS, UNENCLOSED ROOFS AND FLOORS AND SIMILAR ARCHITECTURAL APPENDAGES AND PROJECTIONS SHALL BE CONSTRUCTED AS FOLLOWS: (COUNTY BUILDING CODE 704A.4.1)
  - NON-COMBUSTIBLE CONSTRUCTION (SUCH AS CONCRETE OR METAL)
  - FIRE-RETARDANT TREATED WOOD (PRESSURE-TREATED WITH FIRE RETARDANT, LISTED FOR EXTERIOR USE, INSTALLED PER LISTING)
  - HEAVY TIMBER CONSTRUCTION (MINIMUM DIMENSIONS 3X DECKING, 6X6 COLUMNS, 4X10 OR 6X8 BEAMS, 4X8 JOISTS)
  - ONE-HOUR FIRE-RESISTIVE CONSTRUCTION. THE COUNTY WILL ALSO ACCEPT DECKS WITH A NON-COMBUSTIBLE SURFACE SUCH AS CERAMIC TILES, OR A DECK SURFACE LISTED BY APPROVED EVALUATION SERVICE AS "ONE-HOUR" OR AS A CLASS "A" ROOF COVERING. ALL OTHER EXPOSED SURFACES MUST BE ENCLOSED WITH IGNITION-RESISTANT MATERIALS SUCH AS STUCCO OR CEMENT FIBER MATERIAL. THERE IS NO FIRE-RESISTIVE REQUIREMENTS FOR HANDRAILS AND BALUSTERS
- 10) **FENCES AND OTHER ATTACHEMENTS:** THE FIRST FIVE FEET OF FENCES AND OTHER ITEMS ATTACHED TO A STRUCTURE SHALL BE CONSTRUCTED OF NON-COMBUSTIBLE MATERIAL OR MEET THE SAME FIRE-RESISTIVE STANDARDS AS THE EXTERIOR WALLS OF THE STRUCTURE (COUNTY BUILDING CODE 707A.1)
- 11) **SPARK ARRESTERS:** ALL STRUCTURES HAVING A CHIMNEY, FLUE, OR STOVEPIPE ATTACHED TO A FIREPLACE, STOVE, BARBECUE, OR OTHER SOLID OR LIQUID FUEL BURNING EQUIPMENT OR DEVICE SHALL HAVE THE CHIMNEY, FLU OR STOVEPIPE EQUIPPED WITH AN APPROVED SPARK ARRESTER. SPARK ARRESTERS SHALL BE CONSTRUCTED OF WELDED OR WOVEN WIRE MESH, 12 GAUGE THICKNESS OR LARGER, WITH OPENINGS NO GREATER THAN 3/8", OR OTHER MATERIAL FOUND SATISFACTORY BY THE FIRE MARSHAL (COUNTY FIRE CODE 603.6.6)
- 12) **ROOFING:** ROOFING SHALL HAVE A MINIMUM CLASS "A" FIRE RATING. FOR ROOF COVERINGS WHERE THE PROFILE ALLOWS A SPACE BETWEEN THE ROOF COVERING AND THE ROOF DECKING, THE SPACE AT THE EAVE ENDS SHALL BE FIRE STOPPED TO PRECLUDE ENTRY OF FLAMES OR EMBERS (COUNTY BUILDING CODE 1505)

**MARCO CO.**  
 HOUSE PLANS & DESIGNS  
 PLANS DRAFTING DESIGN 3D-BUILDING PERMITS

**MARCO A. LAUREANO**  
 LICENSE: 16596  
 WWW.MARCOHOUSEPLANS.COM

**MARCO CO.**  
 HOUSE PLANS & DESIGNS  
 PLANS DRAFTING DESIGN 3D-BUILDING PERMITS

**MARCO A. LAUREANO**  
 LICENSE: 16596  
 WWW.MARCOHOUSEPLANS.COM

PROJECT NAME & ADDRESS:  
**RESENDIZ'S ROOM ADDITION & NEW ROOF STRUCTURE**  
 XXX W. FELICITA AVE. ESCONDIDO, CA. 92025

CONSULTANT:

REVISIONS:

1	04/11/2017
2	02/23/2017

DATE: 02/23/2017  
 SCALE: AS SPECIFIED  
 DRAWN & PREPARED BY: MARCO A. LAUREANO  
 SHEET: A-5  
 OF: 15